

Thank you for choosing the Minoura **BikePit-4**. BikePit-4 is a very convenient and easy to set up bike storage stand that can be installed in any room where the ceiling height is between 1.7 and 3.1 meters high.

BikePit-4 comes with two sets of bike hangers. You can add some more optional attachments on the pillar.

Read this instructions manual carefully before use for your safety, and keep on hand for future reference.

Part Name

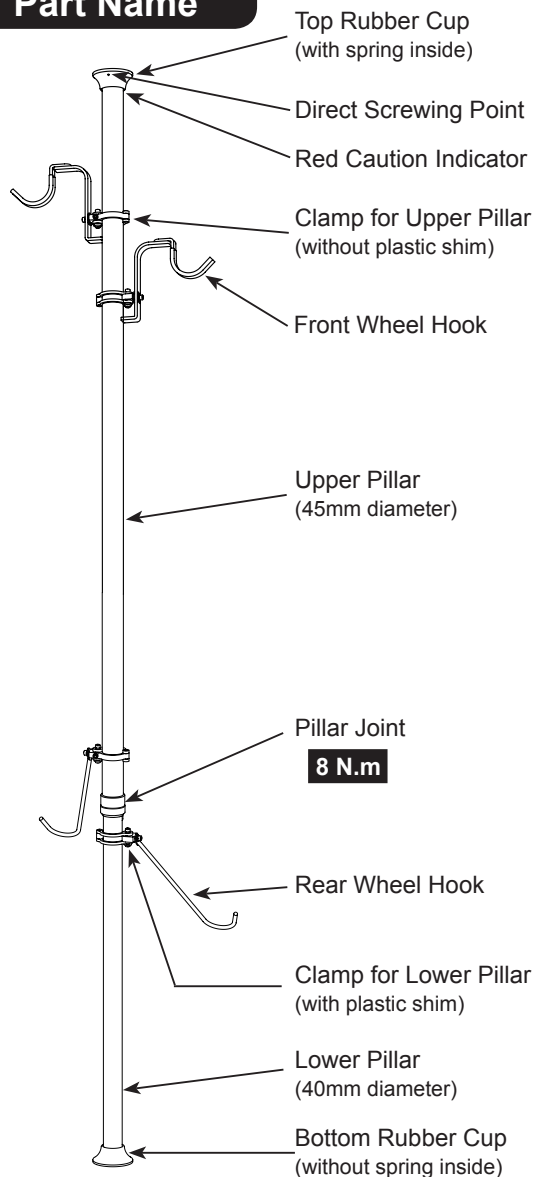

[Pillar Joint]

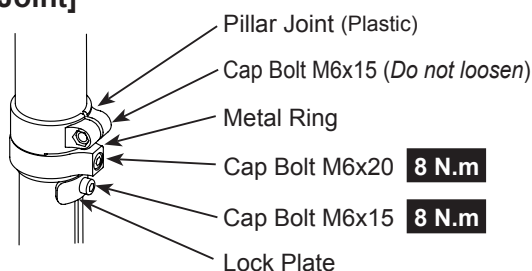

Recommended Tightening Torque = 8 N.m

Important Notes

- For standard 2-wheel bike only. Not for use with tandems, long wheelbase bikes, too small rear wheel bikes, quite heavy E-bikes or DH bikes due to the difficulty of hanging bike vertical.
- Max load limit of the pillar is 50 kgs. Please note, if you hang only one bike the max load is 20kgs in order to keep the stand balanced.
- Make sure the Front Wheel Hook is high enough to keep the rear wheel from touching the floor.
- Check to make sure the Pillar Joint has remained secure by pulling down the Upper Pillar after tightening the Pillar Joint Bolt and the Lock Plate Bolt. If the pillar has moved after tightening, discontinue using and contact your dealer or Minoura directly. You may need to replace the metal ring of the Pillar Joint.
- The pillar is supported by the internal spring applying pressure to the ceiling. Make sure that the pillar comes in contact with a stud or other reinforced area of the ceiling otherwise the pressure may cause a break through on dry wall or other non-supportive material.
- Use the supplied plastic tie to hold the pillar to the ceiling or the wall to avoid the stand from toppling over if the pillar length was shortened if there was an issue with the locking bolt. Minoura is not responsible to any trouble if you don't use this plastic tie correctly.
- Adjust the pillar length correctly. If the red plastic appears beneath the Upper Rubber Cup, it means the pillar is not adjusted properly (too short).
- Never use BikePit horizontally. It is for vertical use only.
- Do not install the pillar upside down. The narrower pillar must come to the bottom.
- The pillar must be completely vertical, and not at any angle. Failure to do so will cause the stand to fall.
- The rubber cap material may leave a mark on some ceilings or floors. We recommend placing a small piece of fabric or paper between the rubber cup and the ceiling. Do not use a slippery material.
- The Front Fork Hook is covered in a vinyl tube to protect your wheel. Some wheels may incur some damage to printing or decals or the surface of the rim and we suggest removing the vinyl tube and wrapping the hook with bar tape or a similar non-scratching material.
- Depending on the bike size, you may have to change the clamp position from the narrow Lower Pillar to the fat Upper Pillar. In this case, remove the plastic shim from the clamp and install to the pillar directly.
- The pillar is just a single pole so it's easy to turn. Do not place any fragile items or sharp edge articles around the pillar.

How To Set Up Pillar

1) Extend pillar, 2) Adjust pillar length, then 3) Install in room.

- 1** Loosen the M6x20 bolt on the black metal ring of the Pillar Joint.
(Do not loosen the upper bolt)
Now the pillar is ready to extend.
- 2** Place the pillar on the floor, then extend the Upper Pillar toward the ceiling.
When the Top Rubber Cup reaches the ceiling, tighten the M6x20 bolt temporarily to fix the pillar length.
This is the exact size between the floor and the ceiling without compressing the spring.
- 3** Remove the pillar and lay on the floor.
You will extend the pillar 20mm more. (see Fig. A)
1) Loosen the M6x20 bolt
2) Extend the Lower Pillar 20mm more, then
3) Tighten the bolt firmly. (tightening torque = **8 N.m**)
Now you get the correct pillar length.
- 4** Loosen the M6x15 bolt, slide the Lock Plate along the groove on the Lower Pillar toward the Pillar Joint, then tighten the bolt firmly (**8 N.m**) when it touches the Pillar Joint.
This works as a safety precaution to prevent the pillar from sliding even if the Pillar Joint has loosened.
- 5** 1) Place the Upper Rubber Cup against the ceiling then push up to compress the internal spring.
2) While keeping the spring compressed,
3) Slide the Lower Pillar and align it correctly while bringing it in contact with the floor. (see Fig. B)



If you see red plastic part beneath the Top Rubber Cup when you setup the pillar, it's the warning sign that the pillar is not extended enough. Remove from the ceiling, adjust the pillar length properly, and try to install again.

- 6** Grab the Upper Pillar and try to pull down in order to confirm if the Pillar Joint is locked properly.



This confirmation must be done. If the pillar has fallen down without this confirmation, Minoura will not be responsible to any damage caused by this accident. If the pillar has been shortened even if you setup properly, do not use the stand and contact your local dealer or distributor in your country to get replacement parts.

- 7** To avoid any chance of the pillar falling, hold the Upper Pillar to the ceiling or the wall with the supplied plastic tie, or directly hold the Top Rubber Cup to the ceiling by screwing at the designated point. (see Fig. C)
This step is mandatory and critical that you complete.

Wrap the tie around the pillar just beneath the Top Rubber Cup and tighten it, put the screw in the hole on the tip of the tie, then screw it to the ceiling or wall.
Make sure the area you choose to place the screw has a solid backing such as a stud or similar. Do not install into dry wall only.

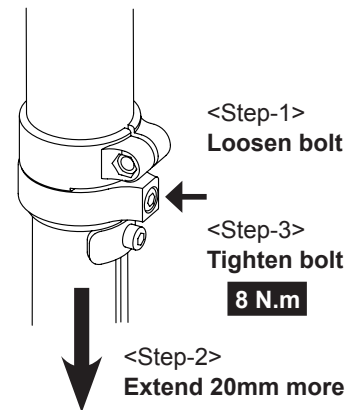

(Fig. A)

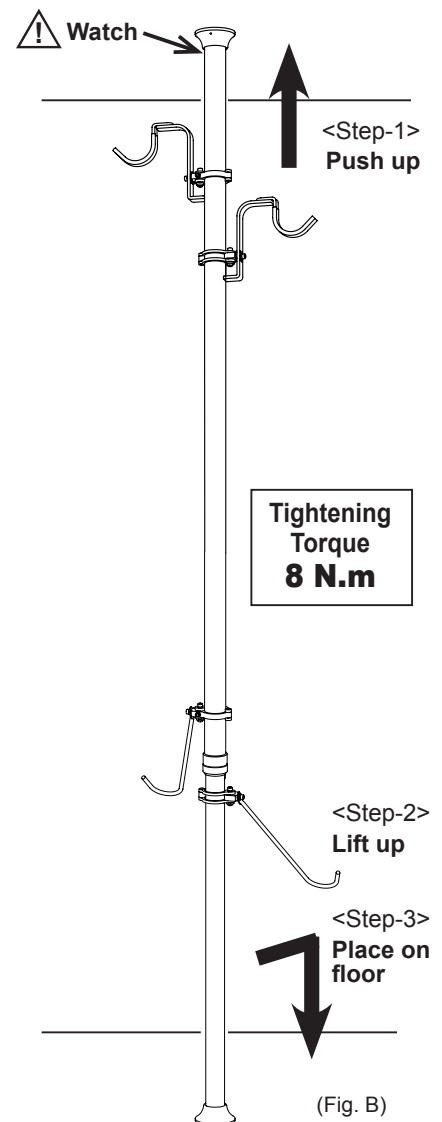

(Fig. B)

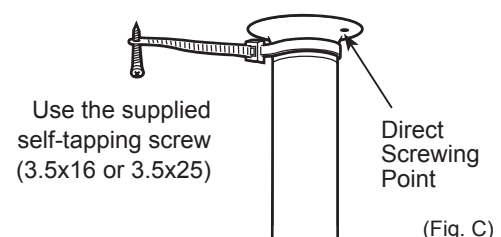

(Fig. C)

How To Install Hooks

Install Front Wheel Hook and Rear Wheel Support to the pillar. Each bike requires one each. Front Wheel Hook must be positioned at enough height that the rear tire doesn't touch the floor.

[Front Wheel Hook]

Front Wheel Hook should be installed alternately to avoid conflicting the handlebar. Both hooks must be set at completely opposite side. Narrower than 180° angle should cause the bikes hit each other.

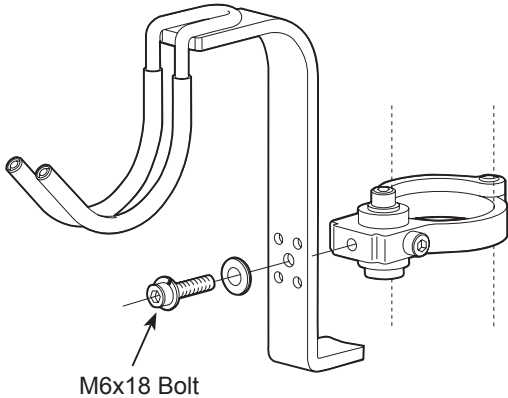

M6x18 Bolt

M6x12 Bolt

[Rear Wheel Hook]

Rear Wheel Support will be installed in the height of the actual rear wheel axle.

If it's installed on the Lower Pillar, you need to set the plastic shim in the clamp.

Just hanging your bike from the top hook doesn't keep the bike vertical. In order to maximize space it's critical that position the rear wheel correctly.

Set the clamp position that the bike becomes vertical when the stay pulls the rear wheel at the furthest point.

Do not hook the rim nor the spoke. The support stay should move, not completely fixed.

How To Re-Install Clamp Band

The clamp bands come pre-installed and they should not need to be removed. However, there may come time when adding options to the BikePit that you will need to remove them.



The clamp is universal with no specific direction. But the Pivot Pin must come from the bottom. If you don't, you will be unable to tighten the bolt with the hex wrench.

1

Remove the Pivot Pin and the bolts from the clamp, and wind the clamp arms around the pillar. Make sure the single side arm is on YOUR right, and the double side arm is on YOUR left in this sentence.

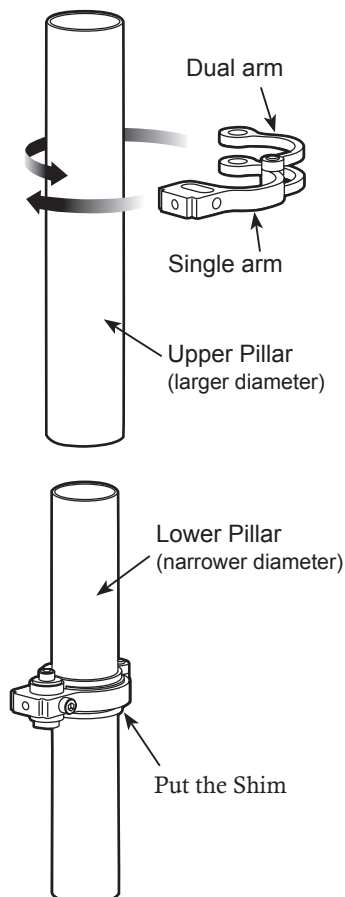

When installing the clamp band to the smaller diameter Lower Pillar, you must put the plastic shim between the band and pillar as a spacer.

Make sure the dual ribs are located on the single arm side.

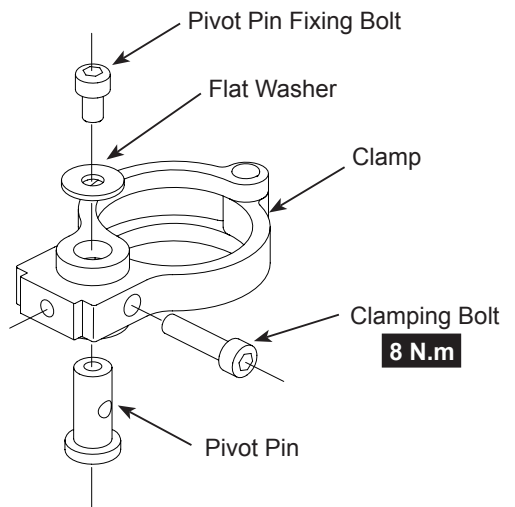

2

Put the Pivot Pin through all 3 holes on the clamp band from bottom side, and screw the Pivot Pin Fixing Bolt with Flat Washer temporarily.



Do not install the Pivot Pin from the top. You will not be able to use the hex wrench.

Do not tighten the Pivot Pin Fixing Bolt firmly yet. If you tighten to much, the next step will become difficult.

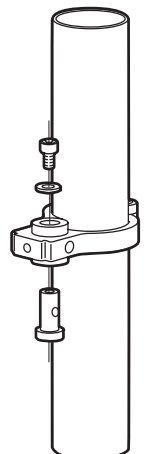

3

Turn the Pivot Pin to align the thread hole to the side hole on the clamp.
Screw the Clamping Bolt into the Pivot Pin.

4

Tighten the Clamping Bolt first, then tighten the Pivot Pin Fixing Bolt firmly. (8 N.m)

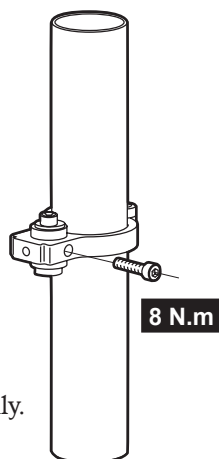

Caution On Front Wheel Hook

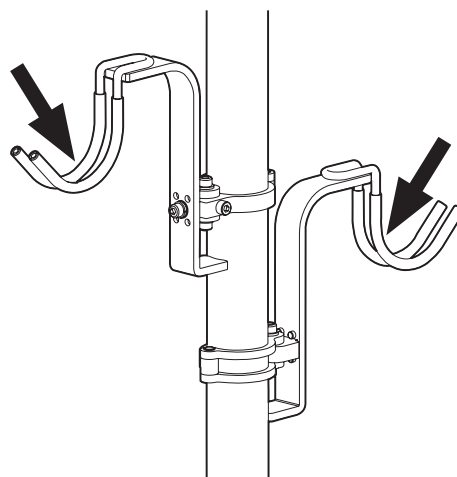

The Front Fork Hook is covered in a vinyl tube to protect your wheel. Some wheels may incur some damage to printing or decals or the surface of the rim and we suggest removing the vinyl tube and wrapping the hook with bar tape or a similar non-scratching material.

In-Use Style

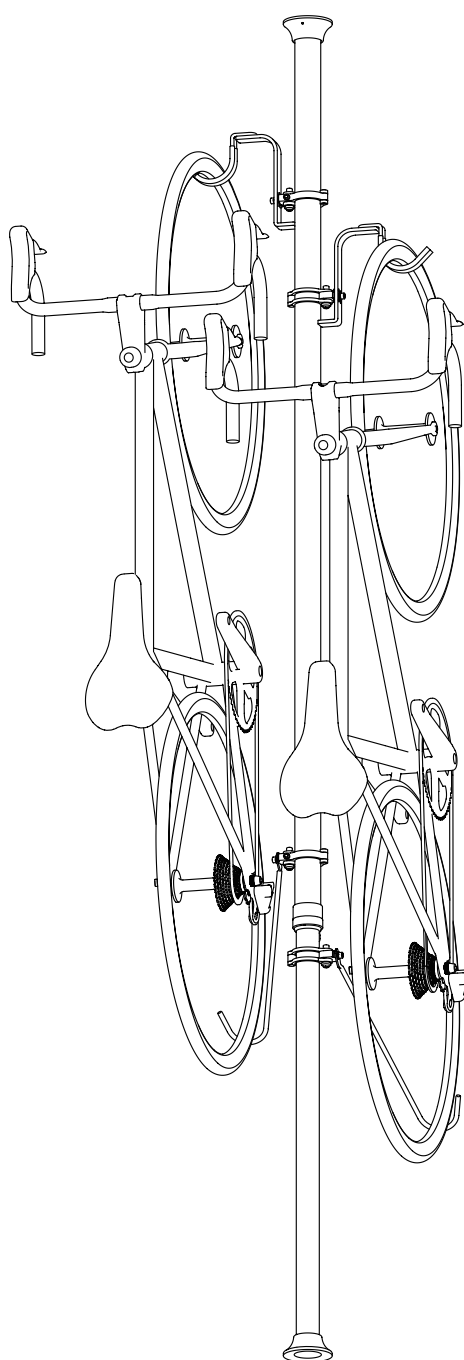

Warranty Period

Minoura offers **1-year limited warranty** to this product from the date of your purchase. Any natural wear and the problems caused by misuse or unapproved modification will not be covered by this program. For more details, read the enclosed **Minoura Limited Warranty Policy** card in the kit. Also please regularly check our Minoura web site for the latest information.

Contact

MINOURA JAPAN

1197-1 Godo, Anpachi, Gifu 503-2305 Japan
URL: www.minoura.jp
Mail: minoura@minoura.jp

Made in Japan