



Bike Cradle 4's arm has different shape from Bike Cradle 3. It's the bent type in order to enable to place the bike further from the pillar to avoid conflicting with the pedal.

<Applicable Tube Diameter: 38 – 45mm>

40mm = for BikeTower / BikePit upper pillar

45mm = for BikeTower / BikePit lower pillar, P-500 / 600 / 700 pillar



We suggest wrapping the hook with bar tape to minimize discoloring of lighter colored frames.

Schematics

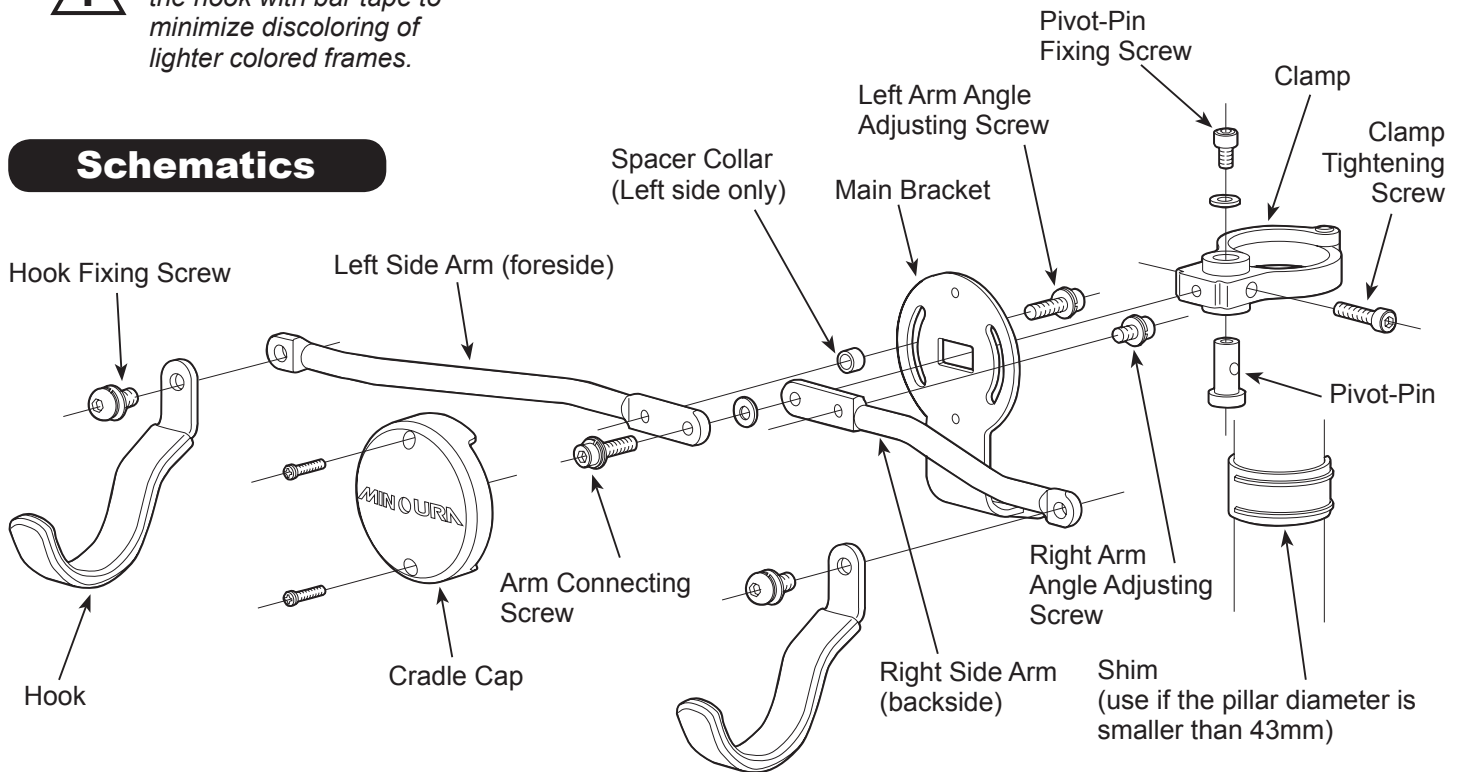

How To Install Cradle4

Required Tool: M5 Hex Wrench (not supplied)

- At first, remove the Pivot-Pin, Pivot-pin Fixing Screw and Clamp Tightening Screw to open the clamp (see Fig. A).

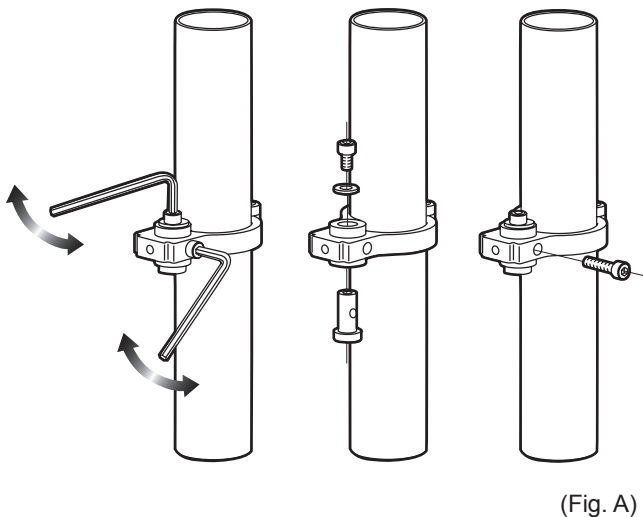

- Widely open the clamp then wind around the pillar. Make sure the single fatter arm is located on the right side, and two narrower arms are located on the left side (see Fig. B). Opposite combination doesn't work.

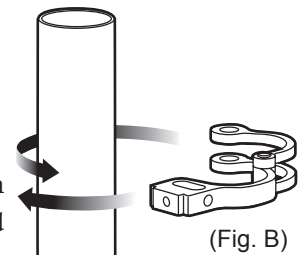

If the pillar diameter is smaller than 43mm, install the supplied plastic Shim first, then wind the clamp over the shim (see Fig. C). Make sure you install the Shim in correct direction. Dual rail must fit to the single arm side.

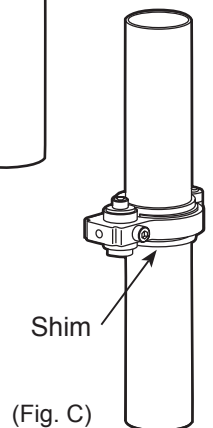

3

Insert the Pivot-Pin to the clamp from bottom hole, and screw the Pivot-Pin Fixing Screw with a washer to hold the pin (see Fig. D).

You don't have to tighten the bolt firmly yet.

4

Rotate the Pivot-Pin to align the thread hole on the pin and the side hole on the clamp body, then screw the Clamp Tightening Screw.

(see Fig. E).

You don't have to tighten the bolt firmly yet.

5

After fixing the clamp height and angle, tighten the Clamp Tightening Screw first (see Fig. F).
(Tightening Torque: 3 N.m)

After that, tighten the Pivot-Pin Fixing Screw to securely hold the clamp.

6

Each arm is fully angle adjustable in +/- 35 degrees in order to fit various types and sizes of bike frame (see Fig. G).

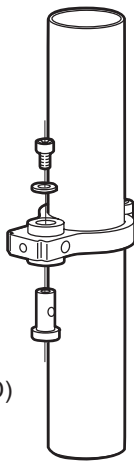

(Fig. D)

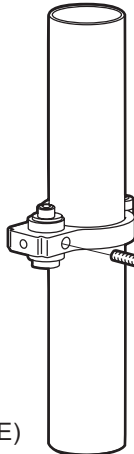

(Fig. E)

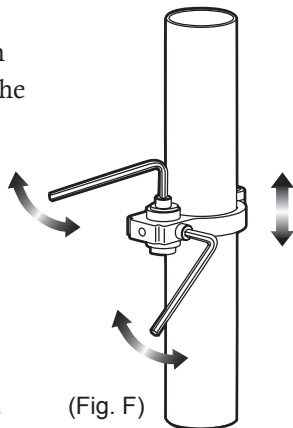

(Fig. F)

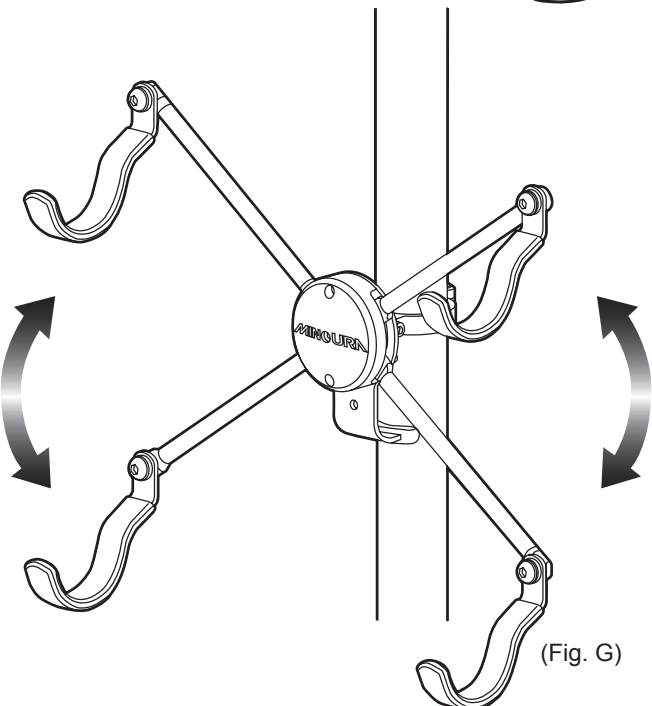

(Fig. G)

7

To change the arm angle, insert an M5 hex wrench into the center hole on the Cradle Cap then loosen the Arm Connecting Screw. (see Fig. H)

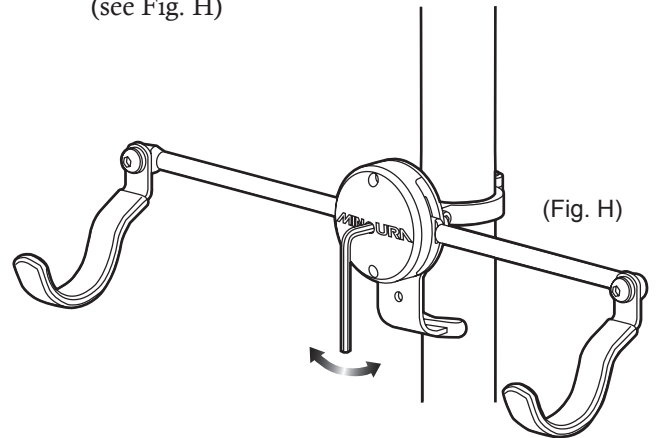

(Fig. H)



Do not remove the Arm Connecting Screw. Just loosen.

8

Loosen the backside screw which holds the arm, grab the arm and change the arm angle. After changing the angle, tighten the screw firmly. (see Fig. I)

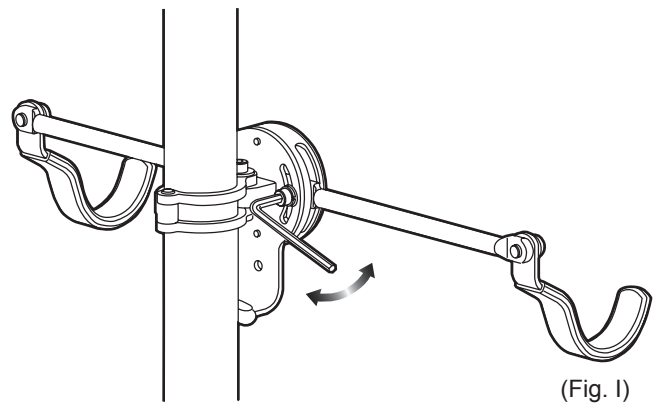

(Fig. I)



Do not set both hooks higher than level. The hook which holds the main load must be located lower than the clamp body.



Tighten every bolt firmly before loading the bike. If the arm fixing screws have been loosened, they may come down due to the bike weight and may drop the bike in the worst case.

Contact

If you need help or have a question, please contact the shop first where you originally purchased this product.

If you cannot get enough service or answer from them, you can contact us directly.

MINOURA JAPAN

1197-1 Godo, Anpachi, Gifu 503-2305

Phone +81-584-27-3131 / Fax +81-584-27-7505

minoura@minoura.jp / www.minoura.jp

Made in Japan